

TF8MHR-07-130I

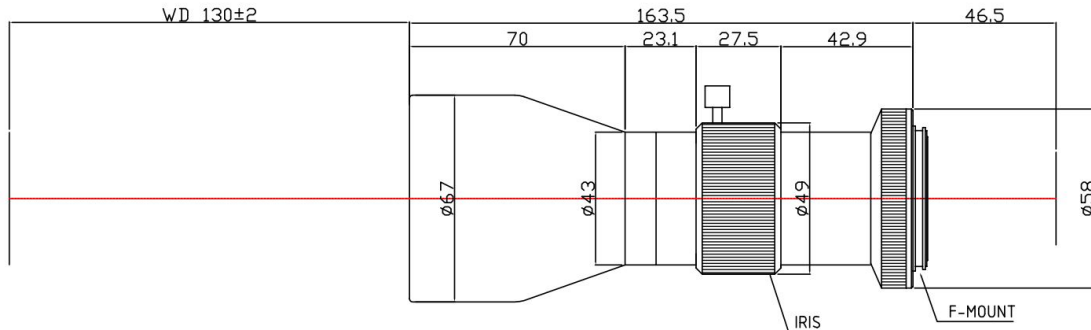

The Object Side Telecentric Lens TF8MHR-07-130I is suitable for sensors up to 8 megapixel and with an image format of 23mm (diagonal).

Technical Data

Art.Gr.	TEL
Magnification	0.7 X
Working Distance (WD)	130 mm
Depth of Field (DOF)	476 µm @CoC 22 µm
Resolution (Object Side)	5.1 µm
Image Format (max.)	23mm (diagonal)
Megapixel (max.)	8 MP
Working F-Number	5.3
Numerical Aperture (NA)	0.066
Field of View (FOV)	25.9mm x 19.4mm
Telecentric Type	Object Side
Telecentricity	0.03 °
Optical Distortion (max.)	0.05 %
Mount Type	F-Mount

