

TCST-60-65C

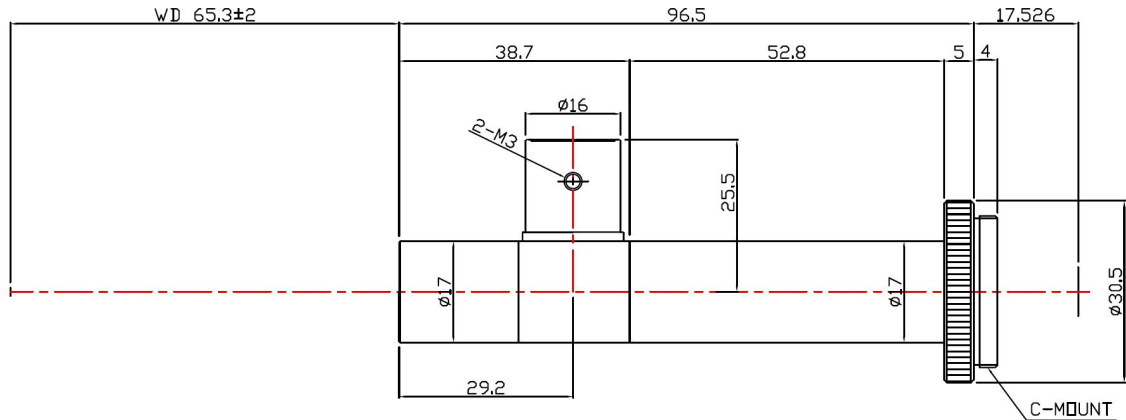

The Object Side Telecentric Lens TCST-60-65C is suitable for sensors with an image format of 1/2 inch.

Technical Data

Magnification	6 X
Mount Type	C-Mount
Aperture (F)	39.5
Working Distance (WD)	65
Depth of Field (DOF)	88 μm
Resolution (Object Side)	4.4 μm
Numerical Aperture (NA)	0.076
Image Format (max.)	1/2 inch
Field of View (FOV)	1.28mm x 0.96mm@1/2" CCD
Telecentric Type	Object Side
Telecentricity	0.04 °
Optical Distortion (max.)	0.06 %
Special Feature	Standard

