

# TCST-50-110

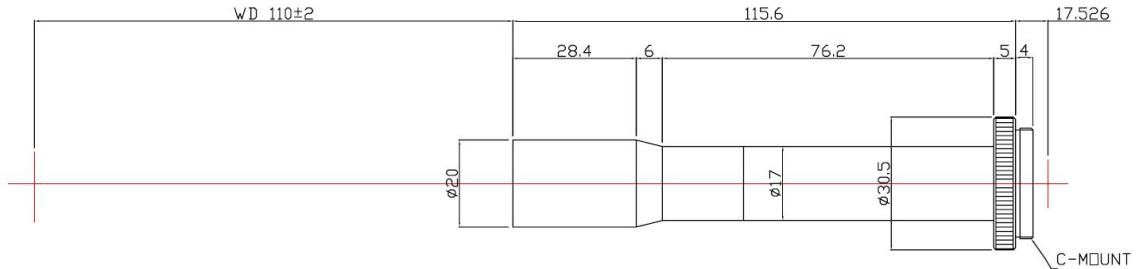

The Object Side Telecentric Lens TCST-50-110 is suitable for sensors with an image format of 1/2 inch.

## Technical Data

Art.Gr.	TEL
Magnification	5 X
Working Distance (WD)	110 mm
Depth of Field (DOF)	133 $\mu\text{m}$ @CoC 40 $\mu\text{m}$
Resolution (Object Side)	5.6 $\mu\text{m}$
Image Format (max.)	1/2 inch
Working F-Number	41.7
Numerical Aperture (NA)	0.06
Field of View (FOV)	1.28mm x 0.96mm @ 1/2"
Telecentric Type	Object Side
Telecentricity	0.01 °
Optical Distortion (max.)	0.14 %
Mount Type	C-Mount

