

TCST-20-40

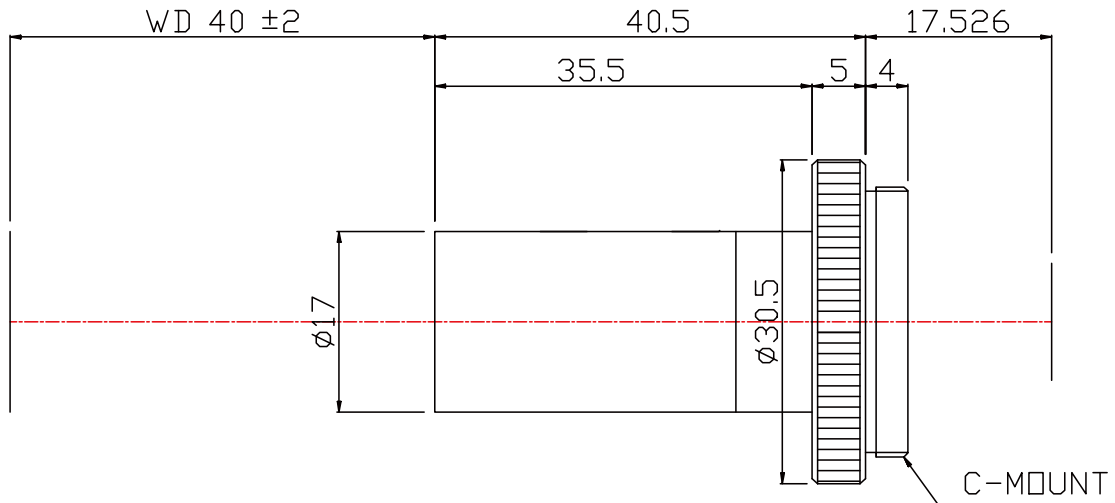

The Object Side Telecentric Lens TCST-20-40 is suitable for sensors with an image format of 1/2 inch.

Technical Data

Art.Gr.	TEL
Magnification	2 X
Working Distance (WD)	40 mm
Depth of Field (DOF)	286 µm @CoC 40 µm
Resolution (Object Side)	4.8 µm
Image Format (max.)	1/2 inch
Working F-Number	14.28
Numerical Aperture (NA)	0.07
Field of View (FOV)	3.2mm x 2.4mm @ 1/2"
Telecentric Type	Object Side
Telecentricity	0.03 °
Optical Distortion (max.)	0.03 %
Mount Type	C-Mount

