

# TCST-15-40C

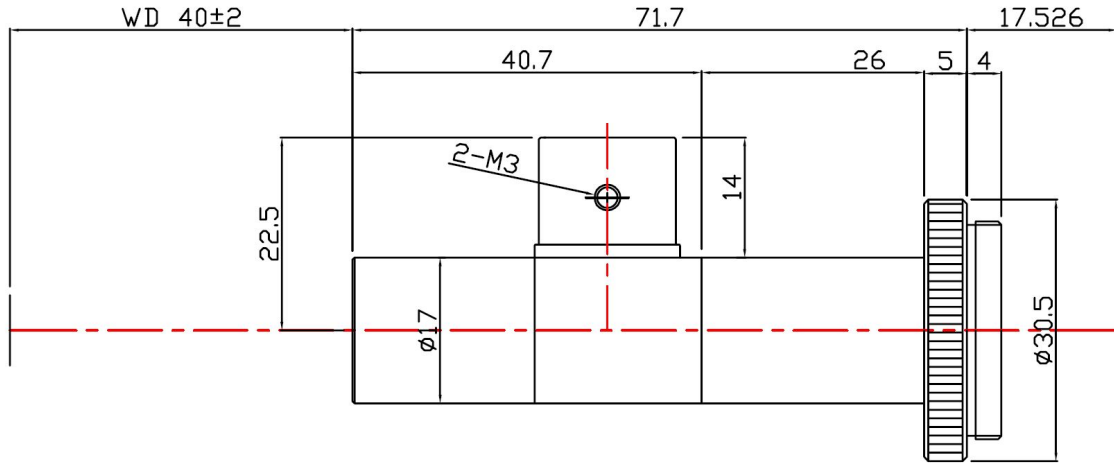

The Object Side Telecentric Lens TCST-15-40C is suitable for sensors with an image format of 1/2 inch.

## Technical Data

Art.Gr.	TEL
Magnification	1.5 X
Working Distance (WD)	40 mm
Depth of Field (DOF)	423 µm @CoC 40 µm
Resolution (Object Side)	5.32 µm
Image Format (max.)	1/2 inch
Working F-Number	11.9
Numerical Aperture (NA)	0.063
Field of View (FOV)	4.26mm x 3.26mm @ 1/2
Telecentric Type	Object Side
Telecentricity	0.03 °
Optical Distortion (max.)	0.05 %
Mount Type	C-Mount

