

TCHR-60-110

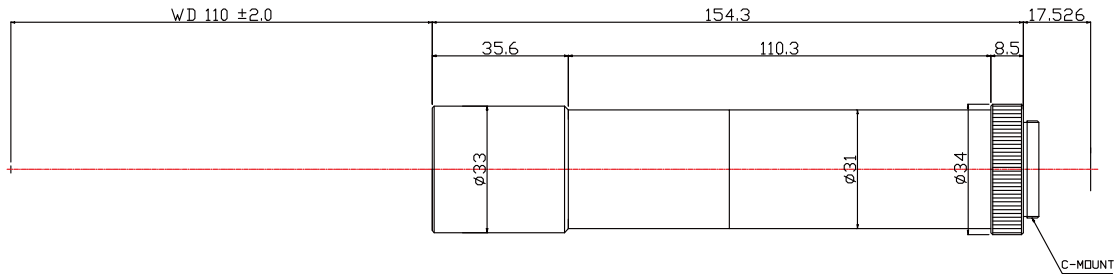

The Object Side Telecentric Lens TCHR-60-110 is suitable for sensors with an image format of 2/3 inch.

Technical Data

Art.Gr.	TEL
Magnification	6 X
Working Distance (WD)	110 mm
Depth of Field (DOF)	74 µm @CoC 40 µm
Resolution (Object Side)	3.72 µm
Image Format (max.)	2/3 inch
Working F-Number	33.3
Numerical Aperture (NA)	0.09
Field of View (FOV)	1.47mm x 1.1mm @ 2/3"
Telecentric Type	Object Side
Telecentricity	0.05 °
Optical Distortion (max.)	0.03 %
Mount Type	C-Mount

