

T25M-045-270I-M58

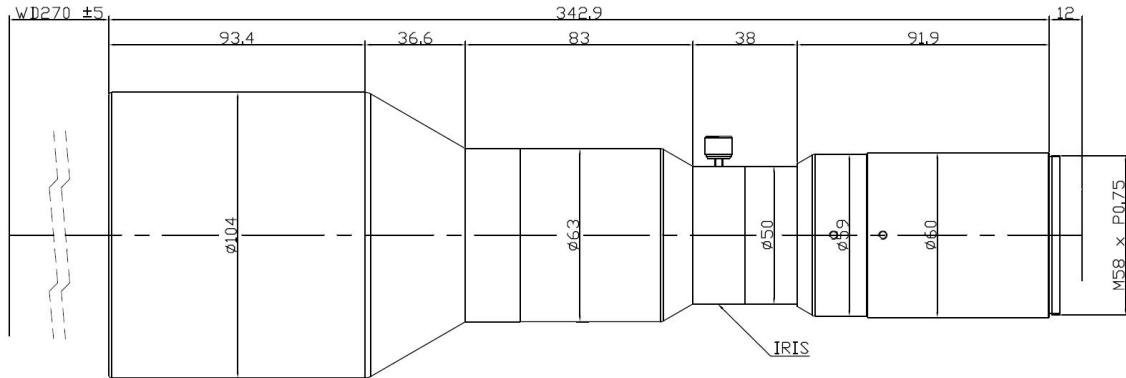

The Object Side Telecentric Lens T25M-045-270I-M58 is suitable for sensors up to 25 megapixel and with an image format of 32mm (diagonal).

Technical Data

Art.Gr.	TEL
Magnification	0.45 X
Working Distance (WD)	270 mm
Depth of Field (DOF)	1100 μ m @CoC 18 μ m
Resolution (Object Side)	9.3 μ m
Image Format (max.)	32mm (diagonal)
Megapixel (max.)	25 MP
Working F-Number	6.25
Numerical Aperture (NA)	0.036
Field of View (FOV)	51.5mm x 51.5mm
Telecentric Type	Object Side
Telecentricity	0.03 °
Optical Distortion (max.)	0.08 %
Mount Type	M58

