

# MC4M-055-160

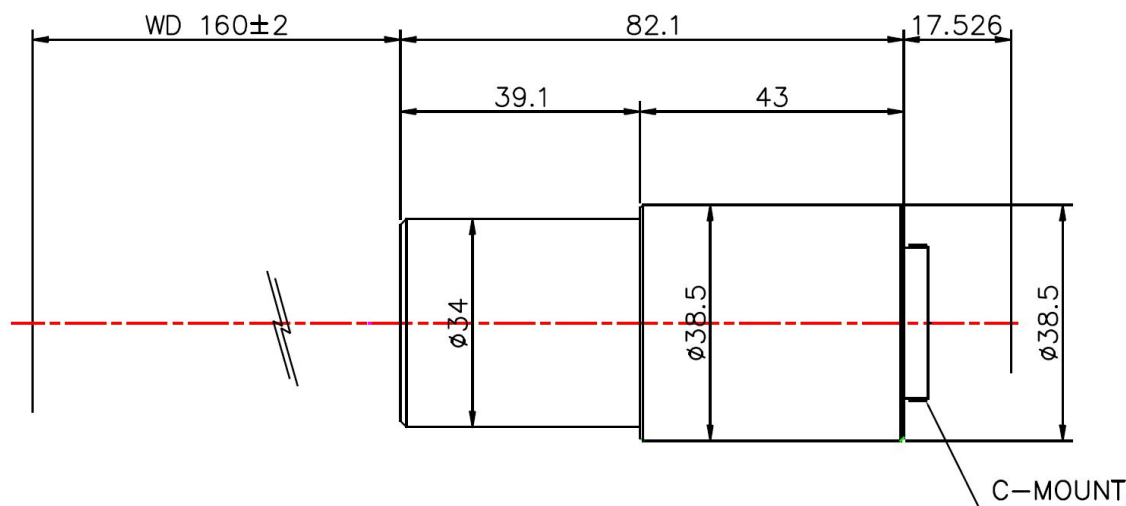

The Macro Lens MC4M-055-160 is suitable for sensors up to 4 megapixel and with an image format of 1 inch.

## Technical Data

Magnification	0.55 X
Mount Type	C-Mount
Aperture (F)	8.1
Working Distance (WD)	160
Depth of Field (DOF)	1200 µm
Resolution (Object Side)	9.9 µm
Numerical Aperture (NA)	0.034
Image Format (max.)	1 inch
Megapixel	4 MP
Field of View (FOV)	20.47mm x 20.47mm@4M CCD
Telecentric Type	Macro
Optical Distortion (max.)	0.06 %

