

B8M3025S125ND

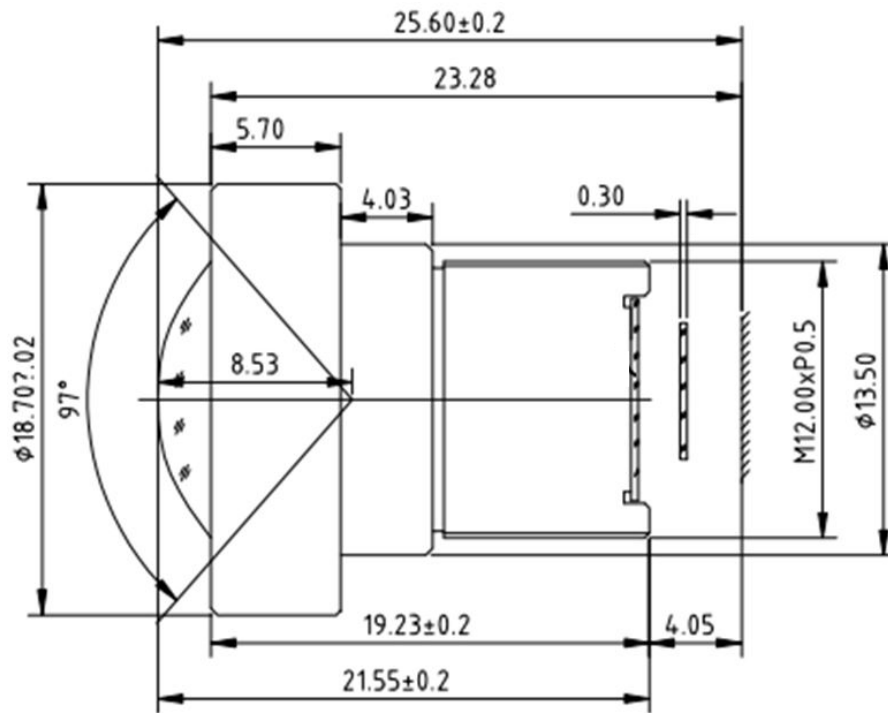

The S-Mount lens Lensagon B8M3025S125ND is suitable for current sensors up to 8.00 megapixel with an image format of 1/2.5 inch.

Technical Data

Mount	S-Mount
Sensor	1/2.5 inch
Focal Length	3.00 mm
Aperture	2.50
MOD	0.20 m
Back Focal	3.74 mm
Angle of View	D:97.00° H:88.00° V:57.00°
Megapixel	8.00 MP
IR Correction	Yes
Optical Distortion	2.00 %
Image Circle	7.20 mm
Iris	fixed
Focus	fixed
Chief ray angle	20.80 °
Typ	Standard



8 Megapixel