

Lensagon B5M12056

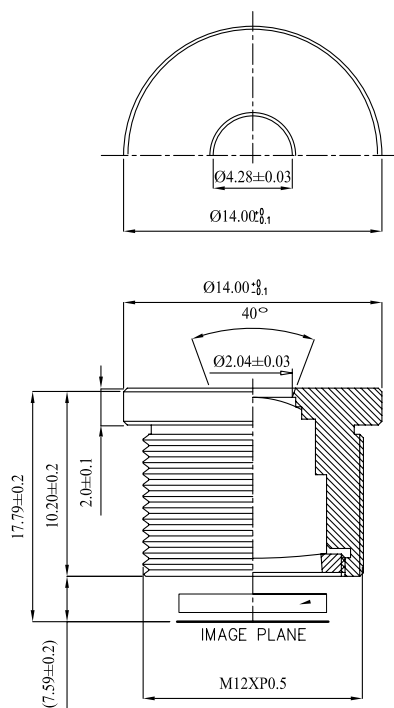

The S-Mount lens Lensagon B5M12056 is suitable for common sensors up to 5 megapixel with an image format of 1/1.8 inch.

Technical Data

| | |
|--------------------|-------------------------|
| Mount | S-Mount |
| Sensor | 1/1.8 - 1/2 inch Sensor |
| Focal Length | 12 mm |
| Aperture | 5.6 |
| MOD | 0.1 m |
| Back Focal | 8.567 mm |
| Angle of View | D:41° H:34.4° V:23.2° |
| Megapixel | 5 MP |
| IR Cut Filter | No |
| Optical Distortion | -1.75 % |
| Image Circle | 9 mm |
| Weight | 7.4 g |
| Iris | fixed |
| Focus | fixed |
| Chief ray angle | 13.7 ° |
| Typ | Standard |



5 Megapixel