

Lensagon B2M3814C

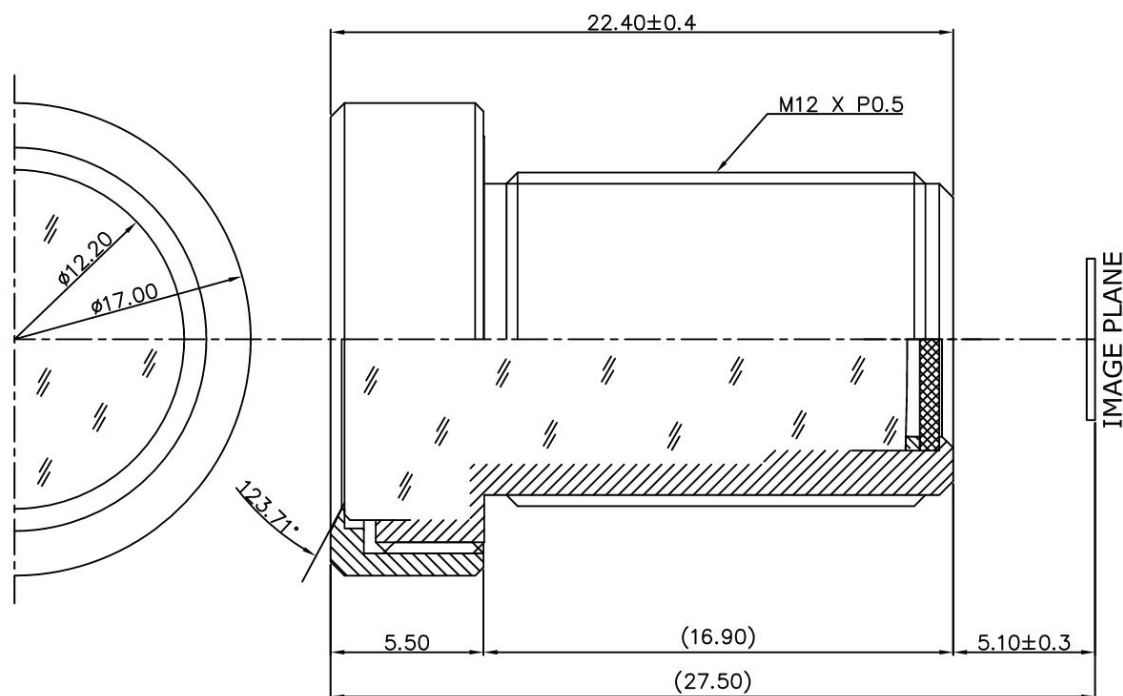

The S-Mount lens Lensagon B2M3814C is suitable for common sensors up to 2 megapixel with an image format of 1/2.5 inch. It is characterized by a particularly high light intensity.

Technical Data

Mount	S-Mount
Sensor	1/2.5 inch
Focal Length	3.85 mm
Aperture	1.4
MOD	0.2 m
Back Focal	6.76 mm
Angle of View	D:121.9° H:91.1° V:56°
Megapixel	2 MP
IR Correction	No
IR Cut Filter	Yes
Image Circle	7.2 mm
Weight	7.7 g
Iris	fixed
Focus	fixed
Typ	Standard



Light Sensitive



2 Megapixel